

MODEL #	T (mm)	L (mm)	Φ (mm)	REMARK
FFST	12~25.4	93.3	≥ 8.1	STANDARD
FFST50	41~53	122	≥ 8.1	LONG
FFST12	1~15	84	≥ 8.1	SHORT
FFST10	4.5~10	93.3	≥ 12.8	ADAPTERS NECESSARY

REVISIONS				
REV.	ZONE	DESCRIPTION	DATE	APP.
1		CLARIFY THE WALL THICKNESS	12/2/22	L.X.

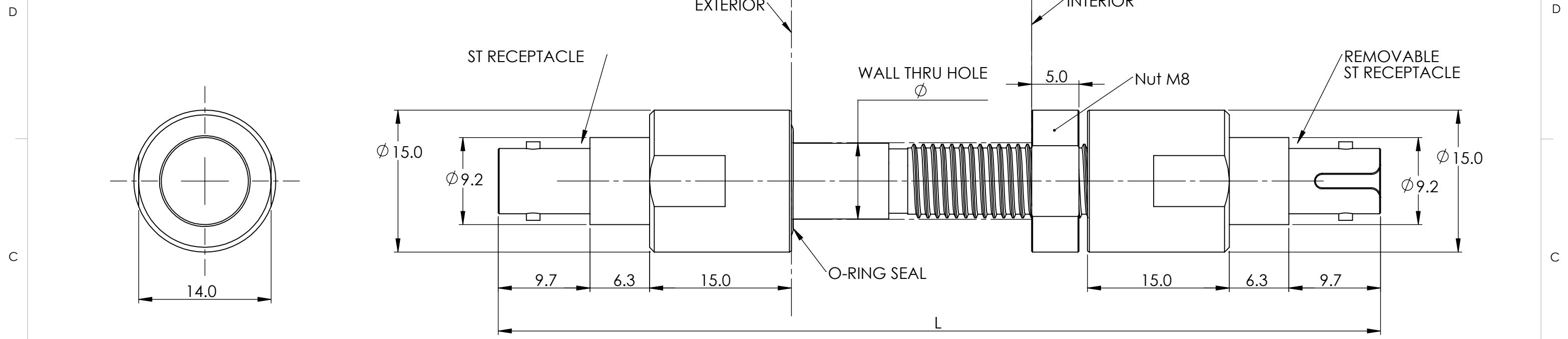

NOTE:

- PART NUMBER CREATE :
MODEL # - WAVELENGTH CODE - FIBER TYPE - PSI
FFST(##) - ### - ## - ##k
- ALL CODE REFERENCE PLEASE SEE PRINCETEL FORJ SELECTION GUIDE.

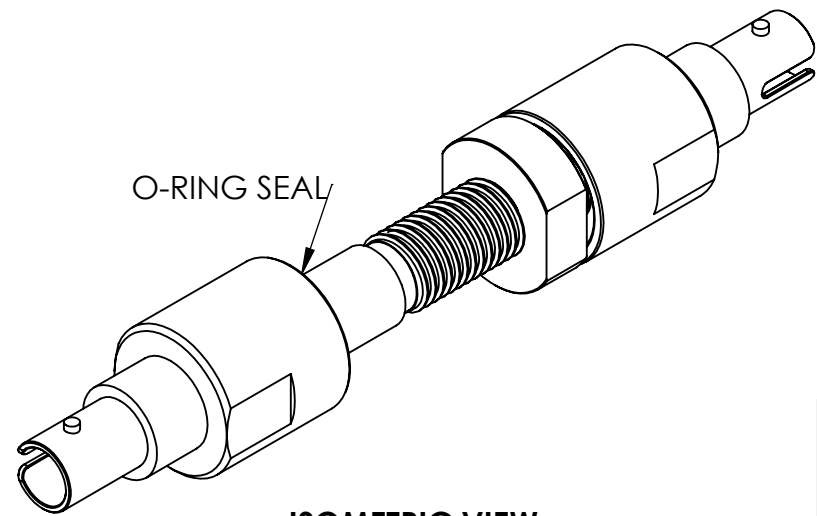

ISOMETRIC VIEW

PROPRIETARY AND CONFIDENTIAL
THE INFORMATION CONTAINED IN THIS DRAWING IS THE SOLE PROPERTY OF PRINCETEL, INC. ANY REPRODUCTION IN PART OR AS A WHOLE WITHOUT THE WRITTEN PERMISSION OF PRINCETEL, INC. IS PROHIBITED.

STANDARD SPECIFICATIONS	
PARAMETERS	VALUES
WAVELENGTH RANGE	650-1650 nm
INSERTION LOSS	<1 DB
RETURN LOSS (SM)	>30 DB (TYPICAL: 40 DB; DEPENDENT ON FLUID TYPE)
OPTICAL POWER HANDLING	23 DBM
WORKING TEMPERATURE	-40 TO 85 C
STORAGE TEMPERATURE	-50 TO 85 C
PACKAGE STYLE	ST RECEPTACLE
HOUSING MATERIAL	STAINLESS STEEL 303
FIBER TYPES	SINGLE OR MULTIMODE
SHAFT DIAMETER	8.0 mm
DESIGNED WALL THICKNESS	1~53 mm (FFST10: ADAPTERS NECESSARY)
PRESSURE RATING	690 BAR (10,000 PSI) OR 69 BAR (1,000 PSI AND VACUUM)

UNLESS OTHERWISE SPECIFIED:

DIMENSIONS ARE IN mm
DO NOT SCALE DRAWING

TOLERANCES:
ANGULAR: ± 1/2°
ONE PLACE DECIMAL ± 0.100
TWO PLACE DECIMAL ± 0.050
THREE PLACE DECIMAL ± 0.025

MATERIAL:

DATE		NAME		PRINCETEL, INC.
DRAWN	4/12/2021	L. X.		
CHECKED	4/12/2021	B. Z.	TITLE:	
ENG APPR.			ST FEED THROUGH	
MFG APPR.				
Q.A.				
COMMENTS: FIRST ANGLE PROJECTION				SIZE DWG. NO. REV
				B FFST-AD 1
PART NO. SEE NOTE 1				SHEET 1 OF 1