

Fiber Polishers (Hand Crank/Motorized)

FP180e

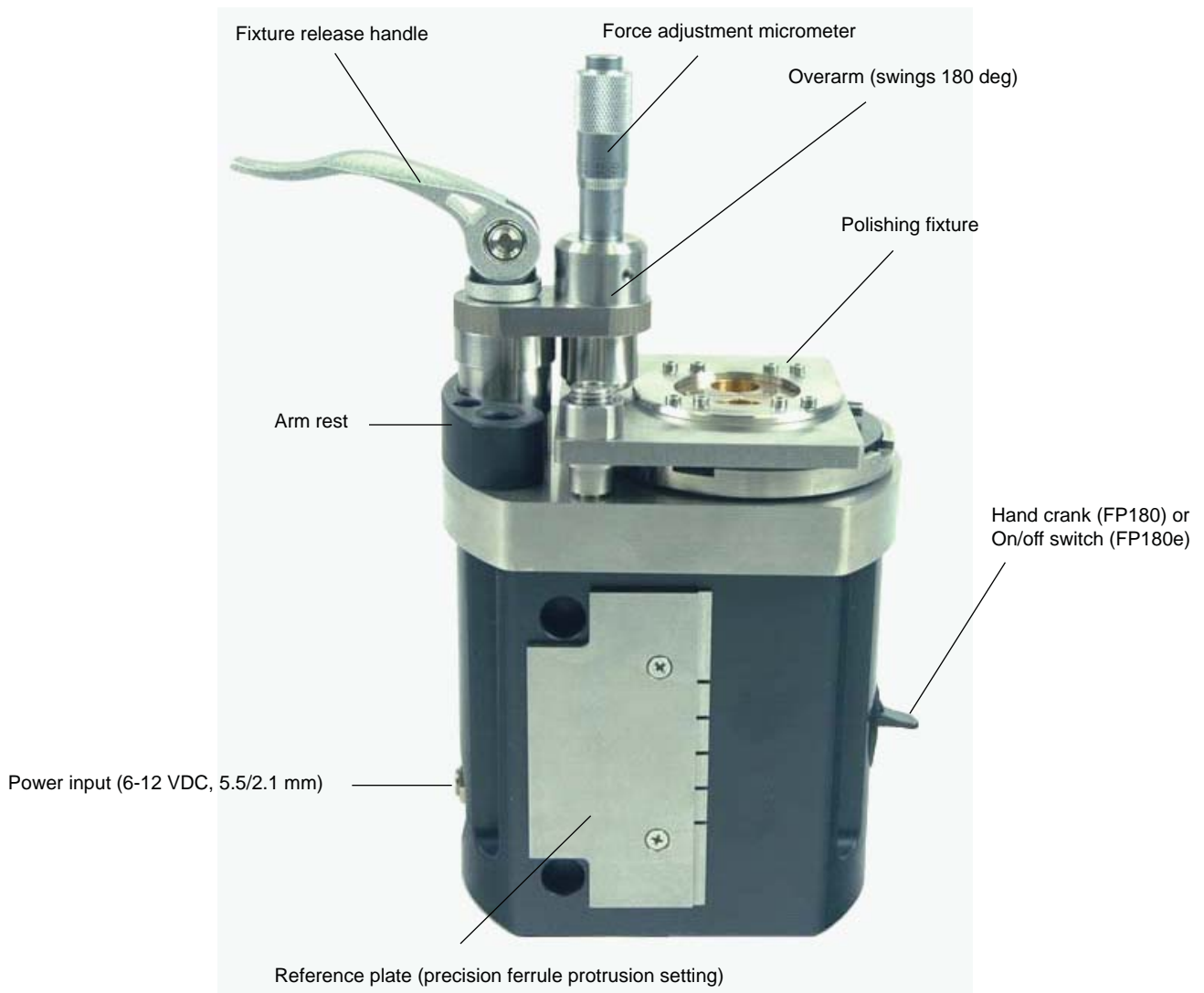

Fiber Polishers (Hand Crank/Motorized)

FEATURES

- Hand crank** allows the machine to operate without wall power or battery (FP180 only)
- Polish** up to two connectors or ferrules simultaneously
- Quick release** for convenient removal of polishing fixture
- Micrometer force adjustment** for perfect pressure on 1 or 2 ferrules and different ferrule sizes
- Low center of gravity** for stability
- Small footprint** for multiple-machine operation
- Quick-change mechanism** allows speedy removal of polishing fixture
- Universal fixture** fits all connectors/ferrules with the same ferrule diameter (PD250 fixture for FC, ST, and SC)
- Reference plate** for precise ferrule protrusion (longer film life, faster run cycle, and higher yield)
- Flexure** mechanism lock/unlock ferrules/connectors in place firmly and quickly

SPECIFICATIONS

Turntable speed	160 rpm (crank or powered)
Planetary/spin speed ratio	1:50
Eccentric distance	5 mm
Force adjustment range	0-1.2 kg (0-11.5 N)
Fixture capacity	2 connectors or ferrules
Suitable screwdriver speed	100-180 rpm
Driver torque (typical)	4.5 N-m (40 lb-in)
Operating temperature	-20 to 65 C
Storage temperature	-40 to 85 C
Power requirement (FP180e)	110/220 VAC, 50/60 Hz, 6 W
DC power input jack	5.5/2.1 mm
Housing material	Machined ABS
Weight (polisher)	~2.5 kg
Weight (fixture)	~0.2 kg
Dimensions (lxwxh)	110x80x200 mm

PART NUMBERS

Polisher with handcrank	FP180
Polisher with 6-12V DC motor	FP180e
Polishing rubber pad (80 durometer)	RP180
Polishing glass disc	GD1
Fixture for 2.5 mm ferrule or FC, SC, & ST	PD250
Fixture for 2.5 mm angled ferrule or FC/APC	PD250FA
Fixture for 2.5 mm angled ferrule or SC/APC	PD250SA
Fixture for 1.25 mm ferrule or LC/PC	PD125
Fixture for 1.25 mm angled ferrule or LC/APC	PD125A
Fixture for 3.18 mm ferrule or SMA905	PD318
Fixture for MTRJ	PDMTRJ
Fixture for 2.00 mm ferrules	PD200
Fixture for 1.80 mm ferrules	PD180
Fixture for 1.60 mm ferrules	PD160

Princetel's FP180 series fiber connector polishers are unique field or lab polishing machines. Model FP180 does not require either wall power or battery, ideal for field use or environments where spark is prohibited. A powered screwdriver can be used to transform the hand polisher into an electrical polishing machine. Model FP180e is equipped with a high-torque DC motor that can operate between 6-12 V DC. A car cigarette lighter outlet is a very handy power source.

Both models allow adjustable force through a micrometer to ensure consistent dome finish for a wide variety of connector types and the number of connectors in the fixture. One can polish one, or two, connectors/ferrules in one polish run. Owning a polisher like these is a significant step forward for someone who is used to polishing connectors by hand using a polishing puck. The improvement in polishing quality is so dramatic one will never want to go back to hand work.

Fiber Polishers (Hand Crank/Motorized)

DIMENSIONS

FP180e

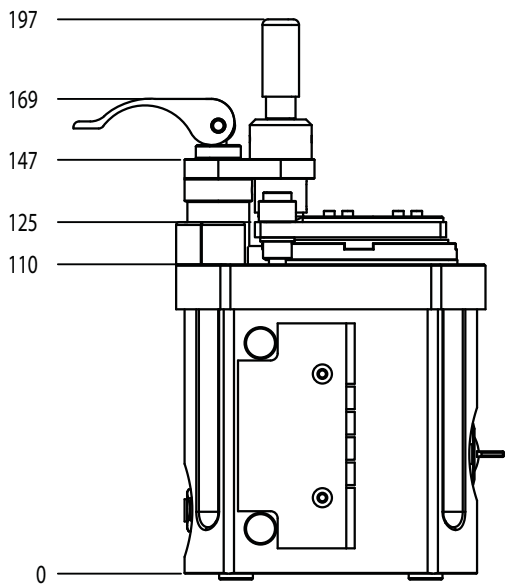
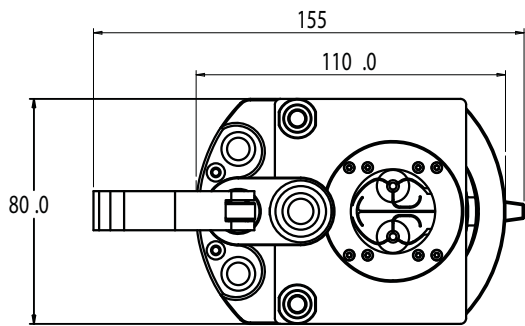

FP180

