

MODEL #	T (mm)	L (mm)	Φ (mm)	REMARK
FFST12M10	1~12.7	84	≥10.1	SHORT
FFST25M10	12~25.4	96.3	≥10.1	STANDARD
FFST50M10	41~50.8	122	≥10.1	LONG
FFST80M10	72.5~83	153.5	≥10.1	EXTRA LONG
FFST25M10A	3.5~19	96.3	≥14.8	STANDARD WITH ADAPTER

REVISIONS				
REV.	ZONE	DESCRIPTION	DATE	APP.

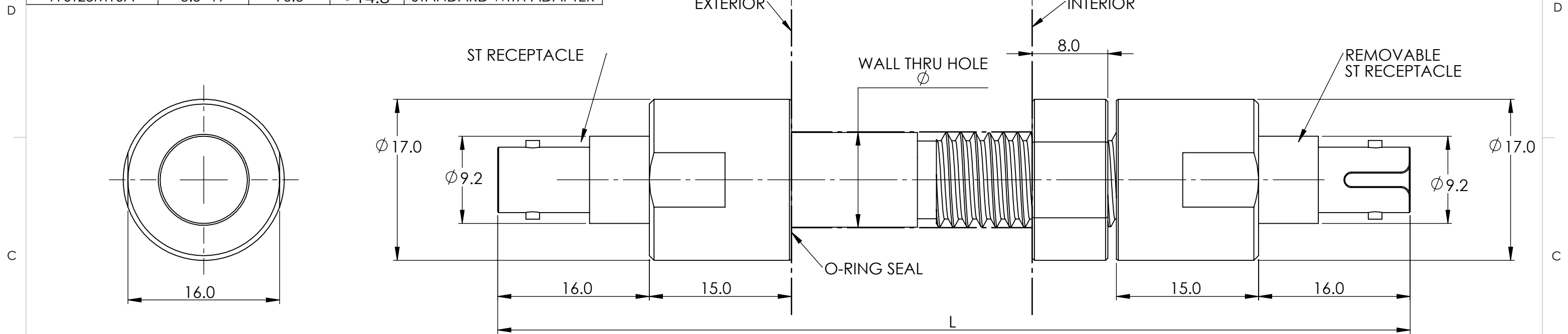

**NOTE:**

- PART NUMBER CREATE :  
MODEL # - WAVELENGTH CODE - FIBER TYPE - PSI  
FFST(##)M10(A) - ### - ## - ##k
- ALL CODE REFERENCE PLEASE SEE PRINCETEL FORJ SELECTION GUIDE.

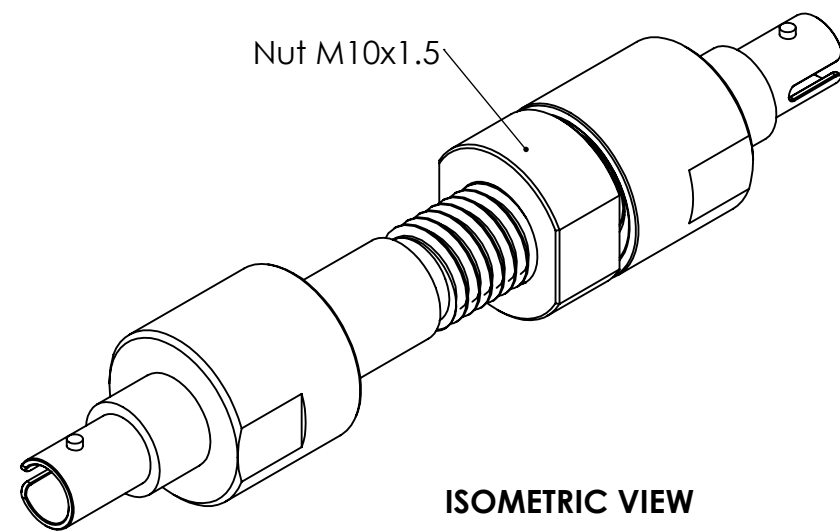

**ISOMETRIC VIEW**

**PROPRIETARY AND CONFIDENTIAL**  
THE INFORMATION CONTAINED IN THIS DRAWING IS THE SOLE PROPERTY OF PRINCETEL, INC. ANY REPRODUCTION IN PART OR AS A WHOLE WITHOUT THE WRITTEN PERMISSION OF PRINCETEL, INC. IS PROHIBITED.

**STANDARD SPECIFICATIONS**

PARAMETERS	VALUES
WAVELENGTH RANGE	650~1650 nm (DEPENDENT ON FIBER TYPE)
INSERTION LOSS	<1 DB
RETURN LOSS (SM)	>30 DB (TYPICAL: 40 DB; DEPENDENT ON FLUID TYPE)
OPTICAL POWER HANDLING	23 DBM
WORKING TEMPERATURE	-40 TO 85 C
STORAGE TEMPERATURE	-50 TO 85 C
PACKAGE STYLE	ST RECEPTACLE
FIBER TYPES	SINGLE MODE OR MULTIMODE
SHAFT DIAMETER	10.0 mm
TIGHTENING TORQUE	2Nm MAX.
HOUSING MATERIAL	STAINLESS STEEL 316
PRESSURE RATING	690 BAR (10K PSI)

**UNLESS OTHERWISE SPECIFIED:**

DIMENSIONS ARE IN mm  
DO NOT SCALE DRAWING

TOLERANCES:  
ANGULAR: ± 1/2°  
ONE PLACE DECIMAL ± 0.100  
TWO PLACE DECIMAL ± 0.050  
THREE PLACE DECIMAL ± 0.025

**MATERIAL:**

DATE	NAME	PRINCETEL, INC.
DRAWN 7/5/2023	L. X.	
CHECKED 7/5/2023	B. Z.	
ENG APPR.		
MFG APPR.		
COMMENTS: FIRST ANGLE PROJECTION		TITLE: <b>ST FEED THROUGH M10 THREADED ROD</b>
SIZE <b>B</b>	DWG. NO. FFSTM10-AD	REV 1
PART NO. <i>SEE NOTE 1</i>		SHEET 1 OF 1

